

ELEIKO IWF WEIGHTLIFTING COMPETITION PLATFORM - OAK BEAMS

3085280

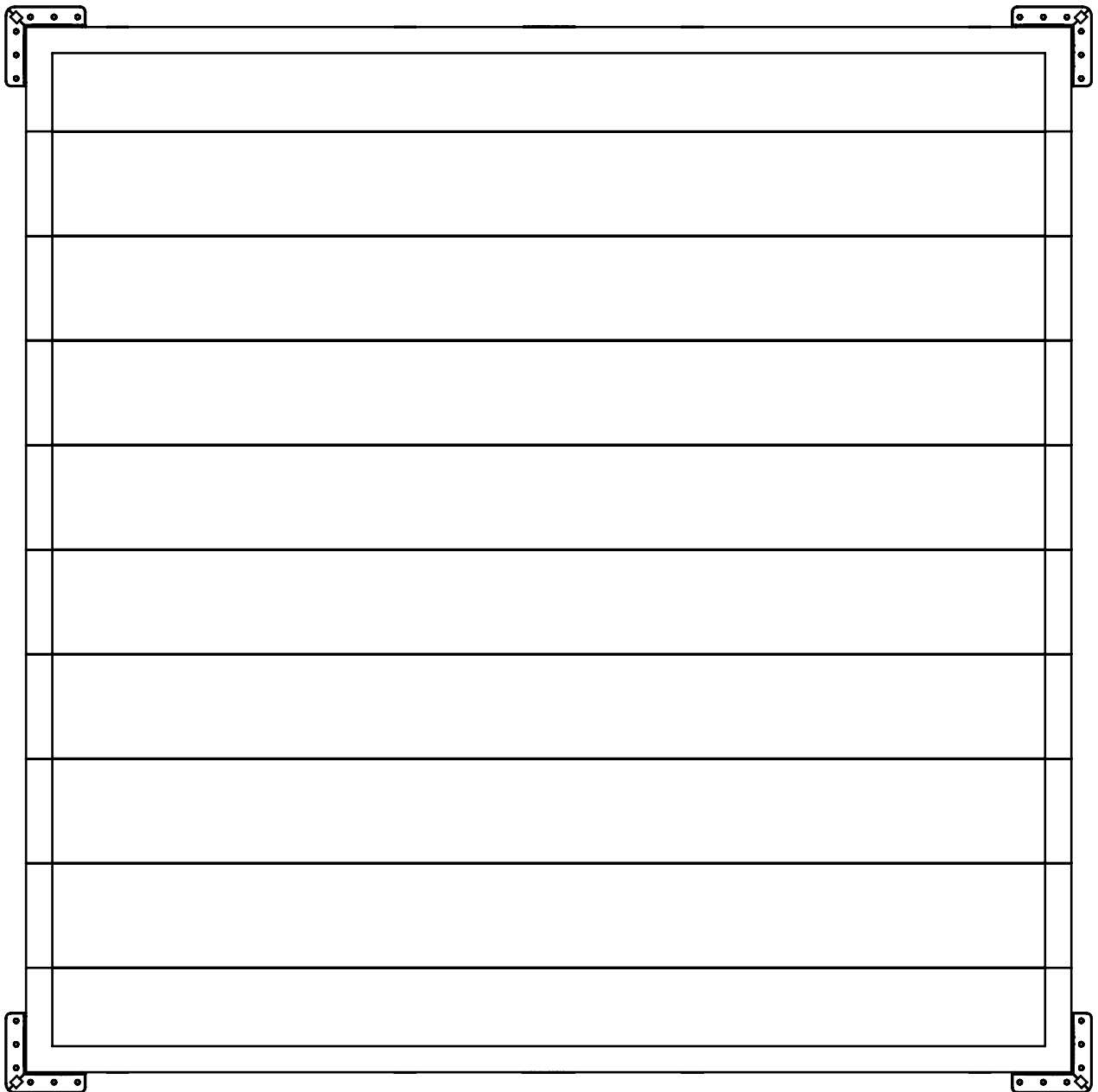

ELEIKO

READ BEFORE INSTALLATION AND USE

CAUTION

The equipment must be installed and used in a place whose access and supervision are specifically controlled by the owner. Wood is a natural material. Wood change properties due to temperature and moisture. The platform is produced and checked indoor with temperature 18-27 C and moisture 37-55 %. If temperature and/or moisture is high/low the wooden platform might change properties. For best lifetime and performance temperature should be 18-27 C and moisture 37-55 %. The color of platform might also change over time, wood is a natural product.

Be sure to install the platform on a stable podium, we recommend Eleiko Podium art no. 3085269. **Cant be to flat or levelled. Slightly inclined podium, the bar will roll of the platform.** Max deviation under platform 2 mm / 1m. ELEIKO recommends that all equipment is secured to floor and installed by a licensed contractor or an ELEIKO-installer.

SAFETY INSTRUCTIONS

It is the responsibility of the purchaser of ELEIKO products to instruct all users and supervising personnel on proper usage of the equipment.

1. All included warnings (labels) and instructions **MUST** be read before the use of any ELEIKO-equipment. Use each equipment as it is intended for.
2. A user **MUST** get a medical examination and proper instructions before the use of any ELEIKO-equipment.
3. **DO NOT** let anyone, under any circumstances, use equipment that appears to be damaged. Do not try to repair any equipment before consulting an ELEIKO technician.
4. **DO NOT** replace the components of ELEIKO-equipment with other none ELEIKO-equipment (magnetic safety pin, frames, bars), do not improvise. If there are any doubts consult an ELEIKO representative prior to any intervention.
5. **DO NOT** overload the equipment and **DO NOT** try to exceed personal strength levels.
6. Children under the age of 14 must be supervised by an adult.
7. **DO NOT** remove any safety labels from the ELEIKO-equipment. ELEIKO is not responsible if a label is removed. Replace damaged labels immediately.

PREVENTITIVE MAINTENANCE , INSPECTIONS & STORAGE

BEFORE USE:

If platform is too slippery, use soap, included in product and water, to clean it. If platform is too dry, apply a thin layer of oil (included in product), let it dry for 15 min, use a cotton rag to wipe of the surplus.

DAILY:

Cleaning of surface: sweep or vacuum the surface when needed, use water and soap, included in product, every evening during competition, if platform is too dry use oil, included in package, to keep the surface in good condition.

Check / Tighten the M16 nuts to keep platform stabil.

REGULARLY:

Clean the surfaces of frames from dust and dirt.

Check that all bolts between parts and floors are properly tightened

STORAGE:

Clean the beams and parts from dust and dirt. Place all beams inside the wooden box, use thin wooden sheets between beams. Make sure to wrap all the beams into plastic. Seal the plastic with tape. Place all the parts for platform inside the box. Close the wooden box with screws. Store the wooden box, indoors, on a flat surface and according to above recommended temperature and moisture levels.

REPAIR AND REFURBISH

This platform is made of 100 % wood which can over time and use show signs of wear, cracks, dents and splinters or similar. The advantage of using 100 % wood is that all above mentioned damage can be repaired and broken parts can be replaced. For minor damage use wood filler, attached with product. Always contact Eleiko for advice,

ELEIKO





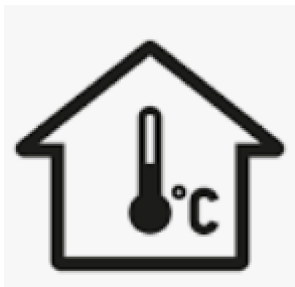

WARRANTY

All products manufactured by ELEIKO are warranted to the original purchaser to be free from defects in workmanship

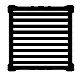
and / or materials under normal use or service as follows:

5 years. Normal wear and tear does not fall under the warranty, above recommendations must be followed.



	 1300 kg
	 250 kg
	 300 kg

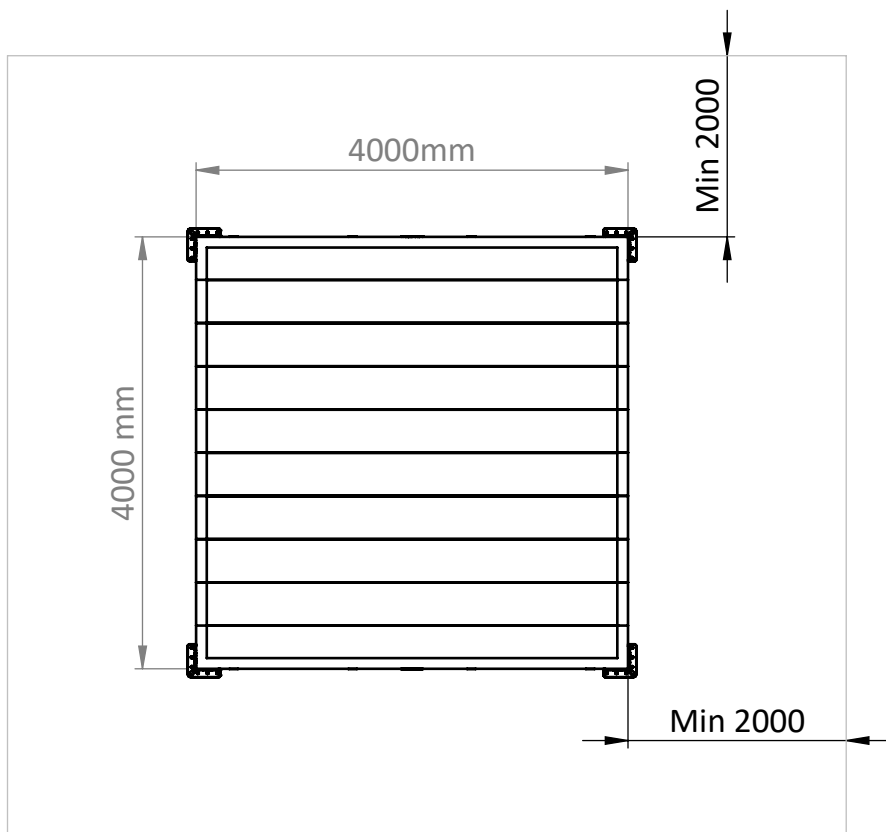

x8



M16 locking

x8



3060795p12

x16

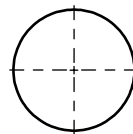

3060386

x4



3001500p57

x1

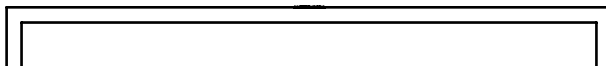

2001068

x8



2001679

x1



2001066

x4

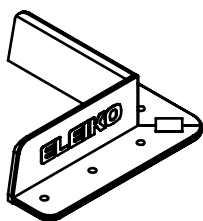

3002021-90a1

x50



3061112

x1



3061822

x2

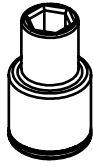

3061105

x2



3061106

x2

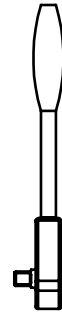

3061104

x1



3061108

x1



3061944

x1



Wood

x1



3061413

x1



3061308

REQUIRED TOOLS

x1

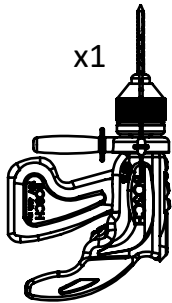

1.

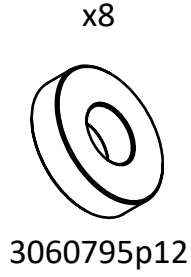
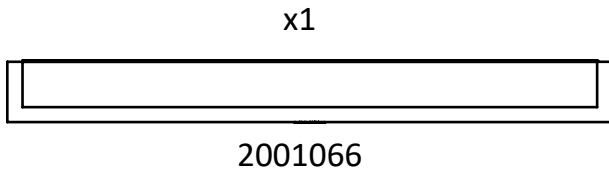

x4

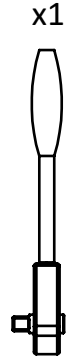

3061104

3061413

x1

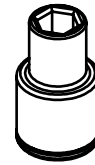

3061105

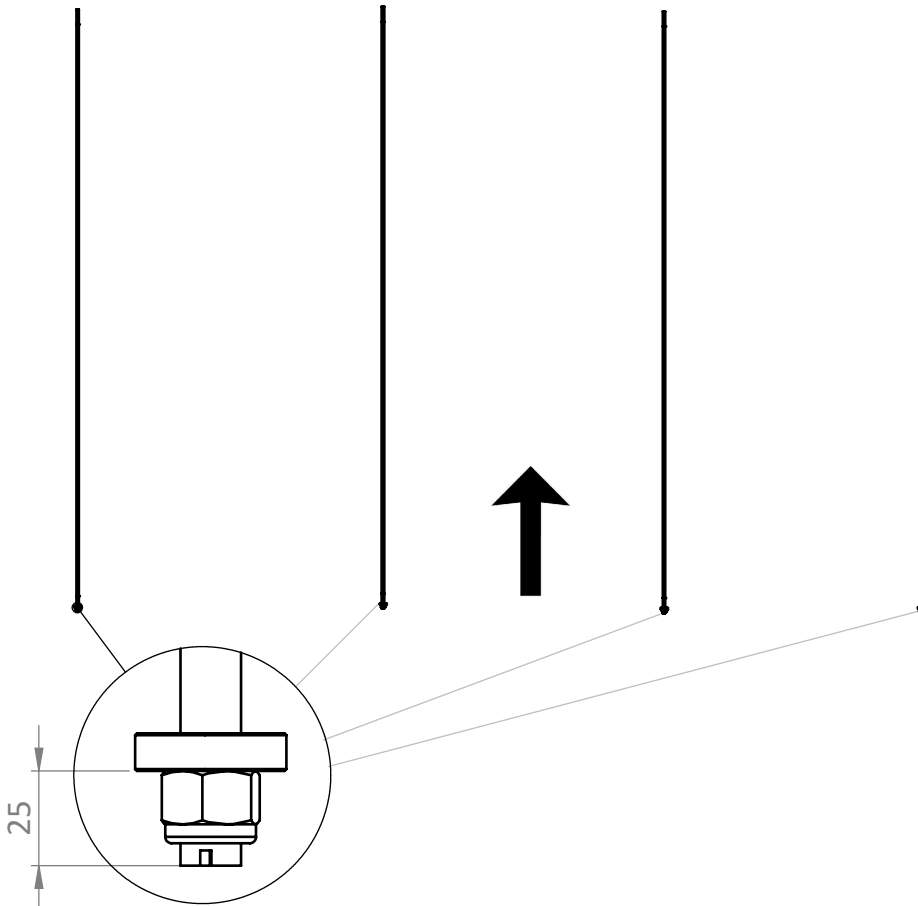

ELEIKO

2.

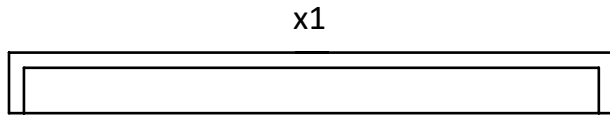

x1

2001068



x8

2001679

x1

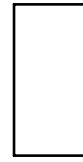

Wood

x1



3061944

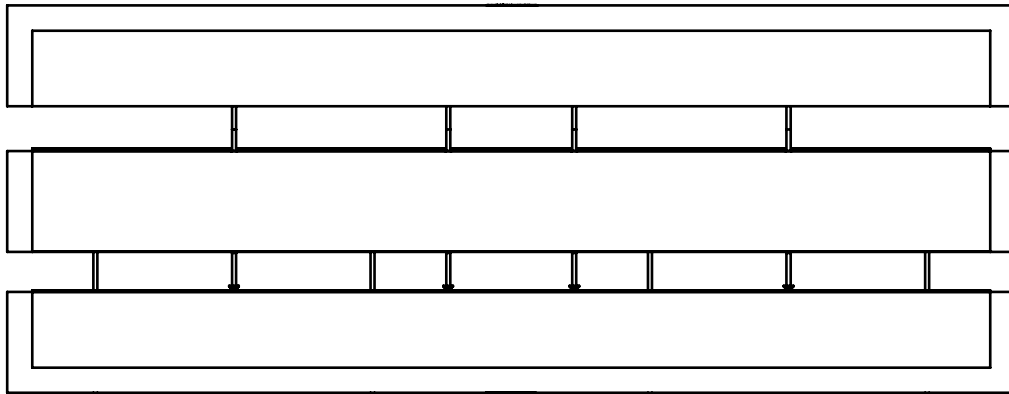

x8



ELEIKO

4.

x8

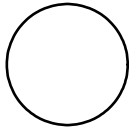

3060386

x4

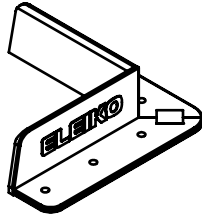

3002021-90a1

x24



3061112

x1



3061822

x2



3061104

x1



3061308

x1

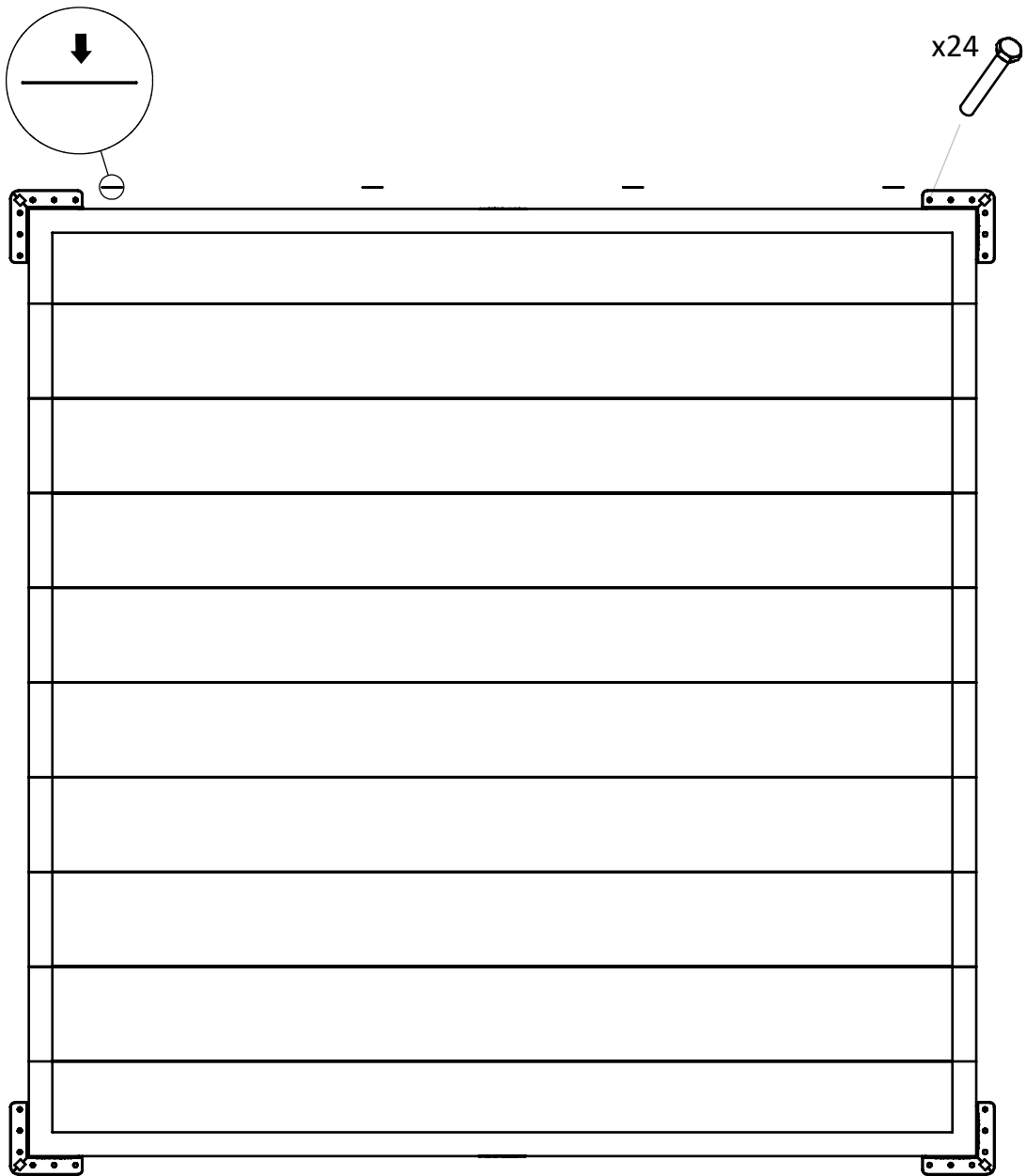
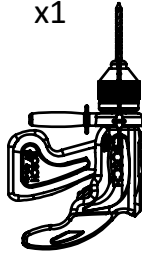

ELEIKO

5.

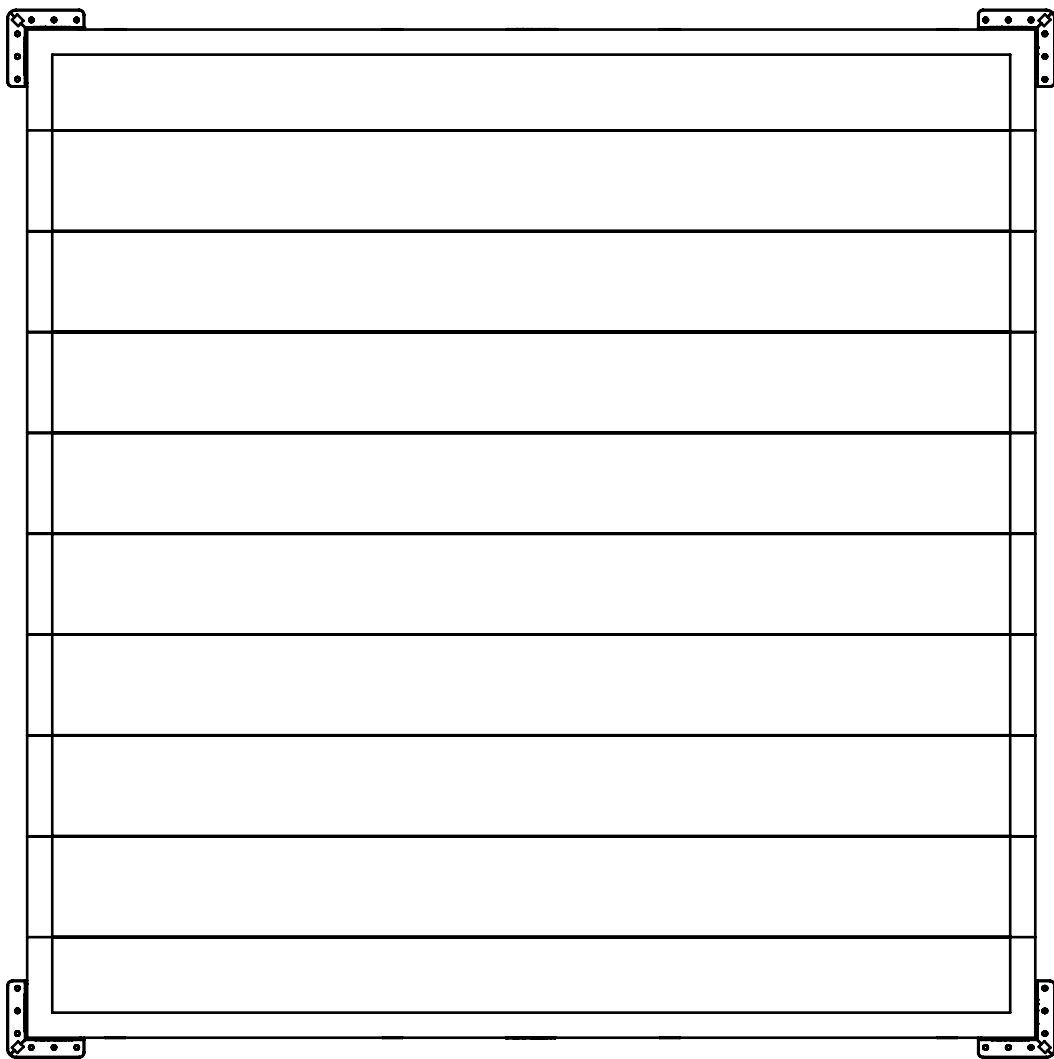

ELEIKO

RAISE THE BAR

Eleiko Group AB | Klastorpsvägen 18 | SE-302 62 HALMSTAD | Sweden
E-mail: info@eleiko.com | Phone: +46 35 17 70 70

www.eleiko.com